

MT/27

SEE NEW BOOK  
ISSUED APRIL/74.

# B.R. Shunting Diesel Locomotive Diagram Book

© COPYRIGHT NOTICE

This PDF file has been created from the original book with permission of BRB Residuary Ltd who, retain copyright in the original document.

This PDF version by David Faulkner, 2013.

Individuals may: use, retain and print out this PDF version for their private information or for that of their non-commercial enthusiast society or railway club.

This document and any copies produced from it in any form may not be sold or lent for any payment in any form other than to cover copying or transmission costs. No reproduction permitted in any other form or circumstance without prior permission from the original copyright holder



## PREFACE

1. It should be noted that this Shunting Diesel Locomotive Diagram Book completely replaces the earlier (page size 11" x 5 $\frac{3}{4}$ ") edition which must be destroyed.
2. A complete set of locomotive diagram books consists of the following:-

DIAGRAM BOOK	PUBLICATION NO.
a) Main Line Diesel Locomotive.	MT/25
b) Electric Locomotive.	MT/26
c) Shunting Diesel Locomotive.	MT/27

Each separate book contains the relevant index sheets to relate the locomotive number to the applicable diagram number.

3. The photographs, where included, depict typical locomotives in their "as built" condition.
4. This diagram book has been updated up to and including JANUARY 1973

issued by:-

Chief Mechanical and Electrical Engineer  
The Railway Technical Centre  
DERBY.

Date : JANUARY 1973

1/27

MT/2

LOCO. NUMBER	DIAGRAM NUMBER	LOCO. NUMBER	DIAGRAM NUMBER	LOCO. NUMBER	DIAGRAM NUMBER	LOCO. NUMBER	DIAGRAM NUMBER	LOCO. NUMBER	DIAGRAM NUMBER	LOCO. NUMBER	DIAGRAM NUMBER	LOCO. NUMBER	DIAGRAM NUMBER	LOCO. NUMBER	DIAGRAM NUMBER	LOCO. NUMBER	DIAGRAM NUMBER	LOCO. NUMBER	DIAGRAM NUMBER	LOCO. NUMBER	DIAGRAM NUMBER								
		2026	DM/200/1					2161	DM/200/1							2366	DM/200/1												
		2027	"	2072	DM/200/1			2162	DM/200/3																				
				2073	DM/200/3			2163	DM/200/1																				
		2029	"			2119	DM/200/1	2164	"							2369	"												
				2075	DM/200/1	2120	"	2165	"																				
				2076	"	2121	"	2166	"																				
								2167	"												2437	DM/200/1							
				2078	DM/200/3			2169	"																				
		2084	DM/200/1	2079	DM/200/1			2169	"													2440	"						
		2085	"	2080	"			2170	DM/200/3																				
				2081	"			2171	DM/200/1																				
		2087	"					2172	"														2397	DM/200/3					
						2128	DM/200/1	2173	"																				
				2084	DM/200/3	2129	"	2174	"															2398	"				
				2086	DM/200/3			2175	"																2444	DM/200/1			
				2044	DM/200/1	2089	DM/200/3	2134	DM/200/1	2179	DM/200/3																		
		2045	"	2090	DM/200/1	2135	"	2180	"																				
				2091	"																								
		2047	"	2092	"	2137	"																						
2004	DM/200/1			2094	DM/200/3																								
2003	"	2030	"	2095	DM/200/1																								
				2096	DM/200/1	2141	DM/200/3																						
2007	"			2097	DM/200/1	2142	"																						
2008	"			2098	"																					2419	DM/200/1		
2009	"			2099	"	2144	DM/200/2	2189	DM/200/1																	2414	"		
2010	"	2055	"			2145	"																				2370	DM/200/1	
		2056	"																								2371	DM/200/3	
2012	"			2102	"	2147	DM/200/1																						
2013	"	2059	"	2103	"																								
2014	"	2052	DM/200/3	2104	"	2149	"																						
		2060	DM/200/1	2105	"																							2429	DM/200/1
2016	"	2061	"	2106	"	2151	"	2194	DM/200/3																			2421	"
2017	"	2062	"	2107	"	2152	"	2197	DM/200/3																			2422	"
2018	"			2108	"	2153	"																					2423	"
2019	"	2063	DM/200/3	2109	"	2154	"																						
		2064	DM/200/1	2109	"	2154	"																						
2020	"	2065	"	2110	"	2155	"																						
2021	"	2066	DM/200/3	2111	"	2156	"																						
2022	"	2067	DM/200/1	2112	DM/200/3	2157	"																					2362	DM/200/1
		2068	"	2113	DM/200/1	2158	DM/200/3																						
		2069	"			2159	DM/200/1																						
2023	"					2160	"																						





LOCO. NUMBER	DIAGRAM NUMBER	LOCO. NUMBER	DIAGRAM NUMBER	LOCO. NUMBER	DIAGRAM NUMBER	LOCO. NUMBER	DIAGRAM NUMBER	LOCO. NUMBER	DIAGRAM NUMBER	LOCO. NUMBER	DIAGRAM NUMBER	LOCO. NUMBER	DIAGRAM NUMBER	LOCO. NUMBER	DIAGRAM NUMBER	LOCO. NUMBER	DIAGRAM NUMBER	LOCO. NUMBER	DIAGRAM NUMBER	LOCO. NUMBER	DIAGRAM NUMBER
		3016	DE/360/1	3061	DE/360/1	3106	DE/360/1			3196	DE/360/1	3241	DE/360/1	3286	DE/360/1	3331	DE/360/1	3376	DE/360/1	3421	DE/360/1
		3017	"	3062	"	3107	"			3197	"	3242	"	3287	"	3332	"	3377	"	3422	"
		3018	"	3063	"	3108	"			3198	"	3243	"	3288	"	3333	"	3378	"	3423	"
		3019	"	3064	"	3109	"			3199	"	3244	"	3289	"	3334	"	3379	"	3424	"
		3020	"	3065	"	3110	"			3200	"	3245	"	3290	"	3335	"	3380	"	3425	"
		3021	"	3066	"	3111	"			3201	"	3246	"	3291	"	3336	"	3381	"	3426	"
		3022	"	3067	"	3112	"			3202	"	3247	"	3292	"	3337	"	3382	"	3427	"
		3023	"	3068	"	3113	"			3203	"	3248	"	3293	"	3338	"	3383	"	3428	"
		3024	"	3069	"	3114	"			3204	"	3249	"	3294	"	3339	"	3384	"	3429	"
		3025	"	3070	"	3115	"			3205	"	3250	"	3295	"	3340	"	3385	"	3430	"
				3071	"	3116	"			3206	"	3251	"	3296	"	3341	"	3386	"	3431	"
		3027	"	3072	"					3207	"	3252	"	3297	"	3342	"	3387	"	3432	"
		3028	"	3073	"					3208	"	3253	"	3298	"	3343	"	3388	"	3433	"
		3029	"	3074	"					3209	"	3254	"	3299	"	3344	"	3389	"	3434	"
2985	DE/304/2	3030	"	3075	"					3210	"			3300	"	3345	"	3390	"	3435	"
2986	DE/304/1	3031	"	3076	"					3211	"			3301	"	3346	"	3391	"	3436	"
2987	DE/304/2	3032	"	3077	"			3167	DE/360/1	3212	"			3302	"	3347	"	3392	"	3437	"
2988	DE/304/1	3033	"					3168	"	3213	"			3303	"	3348	"	3393	"	3438	"
2989	DE/304/2			3079	"			3169	"	3214	"			3304	"	3349	"	3394	"		
2990	DE/304/1			3080	"			3170	"	3215	"			3305	"	3350	"	3395	"		
2991	"	3034	"	3081	"			3171	"	3216	"			3306	"	3351	"	3396	"		
2992	"			3082	"	3127	DE/360/1			3217	"			3307	"	3352	"	3397	"		
2993	DE/209/2			3083	"	3128	"	3172	"	3218	"			3308	"	3353	"	3398	"		
2994	DE/209/1	3039	"	3084	"	3129	"	3173	"	3219	"			3309	"	3354	"	3399	"		
2995	DE/209/2	3040	"	3085	"	3130	"	3174	"	3220	"			3310	"	3355	"	3400	"		
2996	DE/209/1	3041	"	3086	"	3131	"	3175	"	3221	"			3311	"	3356	"	3401	"		
2997	DE/209/2	3042	"	3087	"	3132	"	3176	"	3222	"			3312	"	3357	"	3402	"		
2998	DE/209/1	3043	"	3088	"	3133	"	3177	"	3223	"			3313	"	3358	"	3403	"		
		3044	"	3089	"	3134	"	3178	"	3224	"			3314	"	3359	"	3404	"		
				3090	"	3135	"	3179	"	3225	"			3315	"	3360	"	3405	"		
		3046	"	3091	"			3180	"	3226	"			3316	"	3361	"	3406	"		
		3047	"					3181	"	3227	"			3317	"	3362	"	3407	"		
		3048	"					3182	"	3228	"			3318	"	3363	"	3408	"		
3004	DE/360/1	3049	"					3183	"	3229	"			3319	"	3364	"	3409	"	3454	DE/360/1
3005	"	3050	"					3184	"	3230	"			3320	"	3365	"	3410	"	3455	"
		3051	"					3185	"	3231	"			3321	"	3366	"	3411	"	3456	"
3007	"	3052	"					3186	"	3232	"			3322	"	3367	"	3412	"	3457	"
3008	"	3053	"					3187	"	3233	"			3323	"	3368	"	3413	"	3458	"
3009	"	3054	"					3188	"	3234	"			3324	"	3369	"	3414	"	3459	"
3010	"	3055	"					3189	"	3235	"			3325	"	3370	"	3415	"	3460	"
		3056	"					3190	"	3236	"			3326	"	3371	"	3416	"	3461	"
3012	"	3057	"	3102	DE/360/1			3191	"	3237	"			3327	"	3372	"	3417	"	3462	"
		3058	"	3103	"			3192	"	3238	"			3328	"	3373	"	3418	"	3463	"
		3059	"	3104	"			3193	"	3239	"			3329	"	3374	"	3419	"	3464	"
3015	"	3060	"	3105	"			3194	DE/360/1	3240	"			3330	"	3375	"	3420	"	3465	"

LOCO. NUMBER	DIAGRAM NUMBER	LOCO. NUMBER	DIAGRAM NUMBER	LOCO. NUMBER	DIAGRAM NUMBER	LOCO. NUMBER	DIAGRAM NUMBER	LOCO. NUMBER	DIAGRAM NUMBER	LOCO. NUMBER	DIAGRAM NUMBER	LOCO. NUMBER	DIAGRAM NUMBER	LOCO. NUMBER	DIAGRAM NUMBER	LOCO. NUMBER	DIAGRAM NUMBER	LOCO. NUMBER	DIAGRAM NUMBER	LOCO. NUMBER	DIAGRAM NUMBER
3466	DE/360/1	3511	DE/360/1	3556	DE/360/1	3601	DE/360/1			3691	DE/360/4	3736	DE/360/1	3781	DE/360/1	3826	DE/360/1	3871	DE/360/1	3916	DE/360/4
3467		3512		3557		3602				3692		3737		3782		3827		3872		3917	DE/360/3
3468		3513		3558		3603				3693		3738		3783		3828		3873		3918	DE/360/4
3469		3514		3559		3604				3694		3739		3784		3829		3874		3919	DE/360/1
3470		3515		3560		3605				3695	DE/360/1	3740		3785		3830		3875		3920	DE/360/4
3471		3516		3561		3606				3696	DE/360/4	3741		3786		3831		3876		3921	DE/360/4
3472		3517		3562		3607	DE/360/1	3652	DE/360/1			3742		3787		3832		3877		3922	DE/360/4
		3518		3563		3608		3653				3743		3788		3833		3878		3923	DE/360/4
		3519		3564		3609		3654		3699	DE/360/4	3744		3789		3834		3879		3924	
		3520		3565		3610		3655		3700	DE/360/4	3745		3790		3835		3880		3925	
		3521		3566		3611		3656		3701	DE/360/4	3746		3791		3836		3881		3926	DE/360/4
		3522		3567				3657		3702	DE/360/4	3747		3792		3837		3882		3927	DE/360/1
		3523		3568				3658		3703	DE/360/4	3748		3793		3838		3883		3928	DE/360/4
		3524		3569				3659		3704	DE/360/4	3749		3794		3839		3884		3929	
		3525		3570				3660		3705	DE/360/4	3750		3795		3840				3930	
		3526		3571				3661		3706	DE/360/4	3751		3796		3841		3886		3931	
		3527		3572				3662		3707	DE/360/1	3752		3797		3842		3887		3932	
		3528		3573				3663		3708	DE/360/4	3753		3798		3843		3888		3933	
		3529		3574				3664		3709	DE/360/1	3754		3799		3844		3889		3934	DE/360/1
		3530		3575				3665	DE/360/5	3710		3755		3800		3845		3890		3935	DE/360/4
		3531		3576				3666		3711		3756		3801		3846		3891		3936	DE/360/4
		3532		3577				3667	DE/360/2	3712		3757		3802		3847		3892		3937	DE/360/1
		3533		3578				3668	DE/360/5	3713		3758		3803		3848		3893		3938	
		3534		3579				3669		3714		3759		3804		3849		3894		3939	
		3535		3580				3670	DE/360/5	3715		3760		3805		3850		3895		3940	
		3536		3581				3671	DE/360/2	3716		3761		3806		3851		3896		3941	
		3537		3582				3672	DE/360/1	3717	DE/360/4	3762		3807	DE/360/4	3852		3897		3942	
		3538		3583				3673		3718	DE/360/1	3763		3808		3853		3898		3943	
		3539		3584				3674		3719	DE/360/5	3764		3809		3854		3899		3944	
		3540		3585				3675		3720		3765		3810		3855		3900		3945	
		3541		3586				3676		3721	DE/360/5	3766		3811		3856		3901		3946	
		3542		3587				3677		3722	DE/360/1	3767		3812		3857		3902		3947	
		3543		3588				3678		3723		3768		3813		3858		3903		3948	
		3544		3589				3679		3724		3769		3814	DE/360/1	3859		3904		3949	
		3545		3590				3680		3725		3770		3815	DE/360/4	3860		3905	DE/360/4	3950	
		3546		3591				3681		3726		3771		3816		3861		3906		3951	
		3547		3592				3682		3727		3772		3817		3862		3907	DE/360/4	3952	
		3548		3593				3683		3728		3773		3818	DE/360/1	3863		3908	DE/360/1	3953	
3503	DE/360/1	3549		3594				3684		3729		3774		3819		3864		3909		3954	
3504		3550		3595				3685		3730		3775		3820	DE/360/4	3865		3910	DE/360/4	3955	
3505		3551		3596				3686		3731		3776		3821	DE/360/4	3866		3911	DE/360/4	3956	
3506		3552		3597				3687	DE/360/4	3732		3777		3822	DE/360/4	3867		3912		3957	
3507		3553		3598				3688		3733		3778		3823	DE/360/1	3868		3913	DE/360/4	3958	
3508		3554		3599				3689		3734		3779		3824		3869		3914	DE/360/4	3959	
3509		3595		3600				3690		3735		3780		3825		3870		3915	DE/360/4	3960	

LOCO. NUMBER	DIAGRAM NUMBER	LOCO. NUMBER	DIAGRAM NUMBER	LOCO. NUMBER	DIAGRAM NUMBER	LOCO. NUMBER	DIAGRAM NUMBER	LOCO. NUMBER	DIAGRAM NUMBER	LOCO. NUMBER	DIAGRAM NUMBER	LOCO. NUMBER	DIAGRAM NUMBER	LOCO. NUMBER	DIAGRAM NUMBER	LOCO. NUMBER	DIAGRAM NUMBER	LOCO. NUMBER	DIAGRAM NUMBER	LOCO. NUMBER	DIAGRAM NUMBER
3961	DE/360/1	4006	DE/360/1			4096	DE/360/4	4141	DE/360/4	4186	DE/360/1										
3962	"	4007	"			4097	"	4142	DE/360/4												
3963	"	4008	"			4098	DE/360/1	4143	DE/360/4												
3964	"	4009	"			4099	DE/360/5	4144	DE/360/4							4500	DE/700/1				
3965	"	4010	"			4100	"	4145	DE/360/4							4501	"				
3966	"	4011	"			4101	"	4146	"	4191	DE/360/1					4502	"				
3967	"	4012	"			4102	"	4147	"	4192	"										
3968	"	4013	"			4103	"	4148	"												
3969	"	4014	"			4104	"	4149	"												
3970	"	4015	"			4105	DE/360/5	4150	"												
3971	"	4016	"			4106	DE/360/5	4151	"												
3972	"	4017	"			4107	"	4152	"												
3973	"	4018	"			4108	DE/360/5	4153	"												
3974	"	4019	"			4109	"	4154	"												
3975	"	4020	"			4110	"	4155	DE/360/4												
3976	"	4021	"			4111	"	4156	"												
3977	"	4022	"			4112	DE/360/5	4157	"												
3978	"	4023	"			4113	"	4158	DE/360/1												
3979	"	4024	"			4114	DE/360/5	4159	"												
3980	"	4025	"			4115	DE/360/4	4160	"												
3981	"	4026	"			4116	DE/360/4	4161	DE/360/1												
3982	"	4027	"			4117	"	4162	DE/360/4												
3983	"	4028	"			4118	DE/360/1	4163	DE/360/1												
3984	"	4029	"			4119	"	4164	"												
3985	"	4030	"			4120	"	4165	"												
3986	"	4031	"			4121	"	4166	DE/360/4												
3987	"	4032	"			4122	"	4167	DE/360/1												
3988	"	4033	"			4123	"	4168	"												
3989	"	4034	"			4124	"	4169	DE/360/4												
3990	"	4035	"			4125	DE/360/4	4170	DE/360/4												
3991	"	4036	"			4126	DE/360/4	4171	"												
3992	"	4037	"			4127	DE/360/4	4172	"												
3993	"	4038	"			4128	"	4173	"												
3994	"	4039	"			4129	DE/360/1	4174	DE/360/4												
3995	"	4040	DE/360/4			4130	DE/360/4	4175	DE/360/4												
3996	"	4041	"			4131	"	4176	"												
3997	"	4042	"			4132	DE/360/4	4177	"												
3998	"	4043	"			4133	"	4178	"												
3999	"	4044	"			4134	DE/360/4	4179	"												
4000	"	4045	"			4135	"	4180	"												
4001	"	4046	DE/360/4			4136	DE/360/4	4181	DE/360/4												
4002	"	4047	DE/360/4			4137	"	4182	DE/360/1												
4003	DE/360/4	4048	DE/360/4			4138	"	4183	DE/360/4												
4004	"					4139	DE/360/4	4184	"												
4005	DE/360/1			4095	DE/360/4	4140	DE/360/4	4185	"												





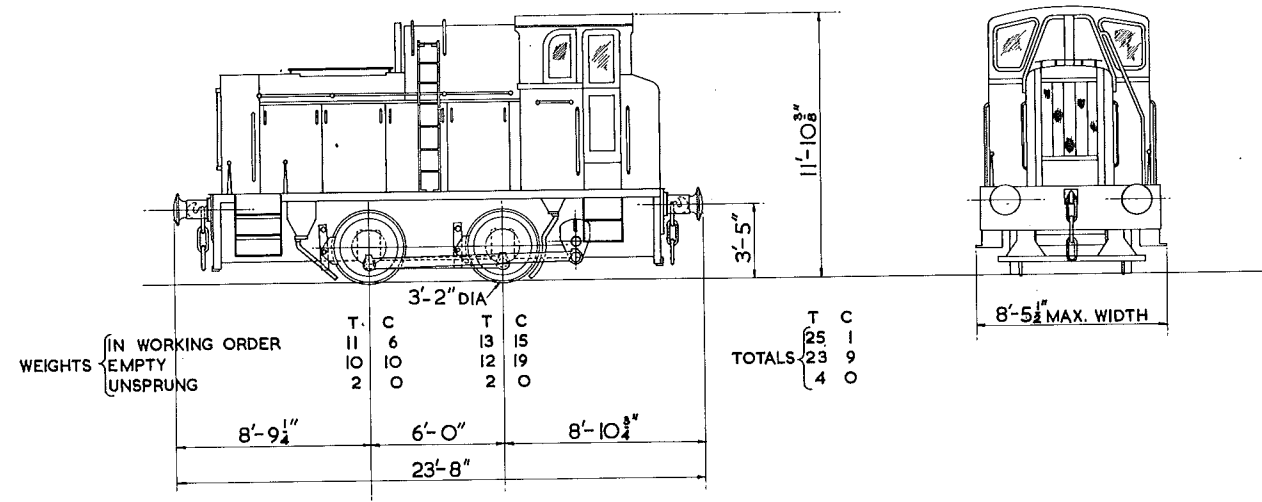

ENGINE	{	MAKE & TYPE.	GARDNER 6L3	BRAKING	{	TYPE {	FOR LOCO.	AIR.
		No. OF CYLS. & CYCLE.	6 CYLS. 4 STROKE.			FOR TRAIN.	—	
TRANSMISSION.	{	MAX. CONT. RATED OUTPUT.	153 H.P. AT 1200 R.P.M.	SPEED	{	BRAKE FORCE {	% OF LOCO. WEIGHT.	62 %
		ENGINE TO GEARBOX.	VULCAN SINCLAIR FLUID COUPLING			IN WORKING ORDER		
PERFORMANCE	{	GEARBOX.	WILSON FOUR SPEED S.E.4	CURVE	{	MAX. PERMITTED SERVICE SPEED	14.25 M.P.H.	
		FINAL DRIVE.	WISEMAN UNIT 15 R.L.G.B.			MIN. RAD. CURVE {	WITHOUT GAUGE WIDENING:	1.06 CHAINS.
		MAX. TRACTIVE EFFORT.	12750 LB. AT 22.8% ADHESION	TANK CAPACITY.		AT DEAD SLOW SPEED:	1 CHAIN	
		CONT. TRACTIVE EFFORT.	12750 LB. AT 2.63 M.P.H.	FUEL			325 GALLS.	

**150 H.P. ANDREW BARCLAY O-4-O DIESEL MECHANICAL SHUNTING LOCOMOTIVE CLASS O1**

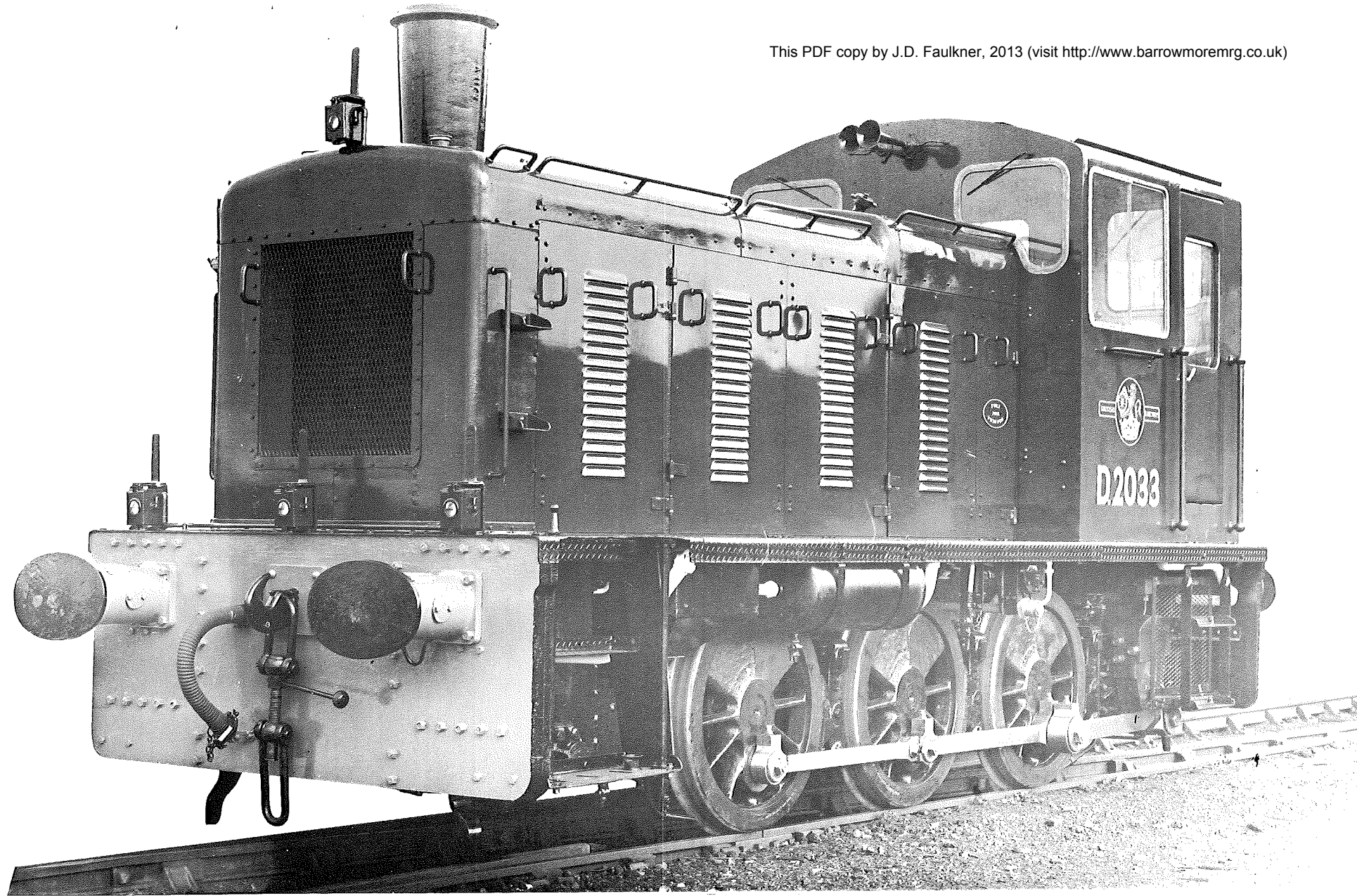

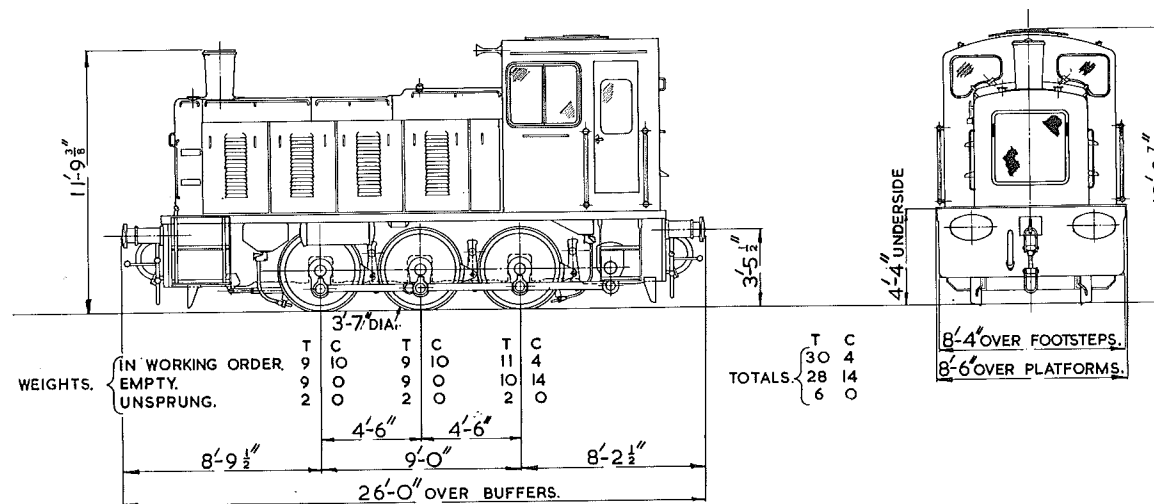

ENGINE.	{	MAKE & TYPE.	GARDNER 8 L.3.	BRAKING.	{	TYPE.	{ FOR LOCO.	AIR.
		No. OF CYLS. & CYCLE	8 CYLS. 4 STROKE.			{ FOR TRAIN.	VACUUM.	
TRANSMISSION.	{	MAX. CONT. RATED OUTPUT.	204 H.P. AT 1200 R.P.M.	SPEED.	{	BRAKE FORCE.	{ % OF LOCO. WEIGHT	70 %.
		ENGINE TO GEARBOX.	FLUIDRIVE TYPE 23 HYD. COUPLING.			{ IN WORKING ORDER.		
		GEARBOX.	WILSON-DREWRY C.A.5. R.7.				MAX. PERMITTED SERVICE SPEED.	28.5 M.P.H.
PERFORMANCE.	{	FINAL DRIVE.	S.C.G. Co. TYPE R.F.11.	CURVE.	{	MIN. RAD. CURVE.	{ WITHOUT GAUGE WIDENING:	2 CHAINS.
		MAX. TRACTIVE EFFORT.	15300 LB. AT 22.6 % ADHESION.			{ AT DEAD SLOW SPEED:		
		CONT. TRACTIVE EFFORT.	15300 LB. AT 3.75 M.P.H.	TANK CAPACITY.	FUEL.	300 GALLS.		

**200 H.P. B.R. O-6-O DIESEL MECHANICAL SHUNTING LOCOMOTIVE.  
CLASS O3**

DM/200/2

JUNE 1969

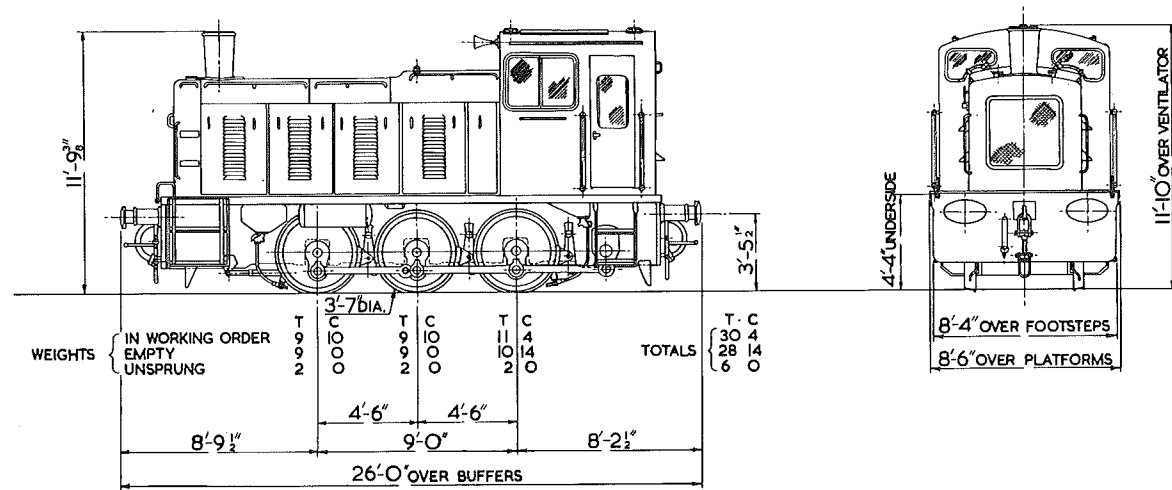

ENGINE.	MAKE & TYPE	GARDNER 8 L.3.	BRAKING.	TYPE.	FOR LOCO.	AIR.
	No. OF CYLS. & CYCLE.	8 CYLS. 4 STROKE.		FOR TRAIN.	VACUUM.	
	MAX. CONT. RATED OUTPUT.	204 H.P. AT 1200 R. P.M.		BRAKE FORCE.	% OF LOCO. WEIGHT. IN WORKING ORDER.	70%.
TRANSMISSION.	ENGINE TO GEARBOX.	FLUIDRIVE TYPE 23 HYD. COUPLING.	SPEED.			MAX. PERMITTED SERVICE SPEED.
PERFORMANCE.	GEARBOX.	WILSON - DREWRY C.A.5.R.7.		CURVE.	MIN. RAD. CURVE.	WITHOUT GAUGE WIDENING:
	FINAL DRIVE.	S.C.G. Co. TYPE R. F. II.	AT DEAD SLOW SPEED:			
	MAX. TRACTIVE EFFORT.	15300 LB. AT 22.6% ADHESION.	TANK CAPACITY.	FUEL.	300 GALLS.	
CONT. TRACTIVE EFFORT.	15300 LB. AT 3.75 M. P.H.					

200 H.P. B.R. O-6-O DIESEL MECHANICAL SHUNTING LOCOMOTIVE.  
CLASS O3

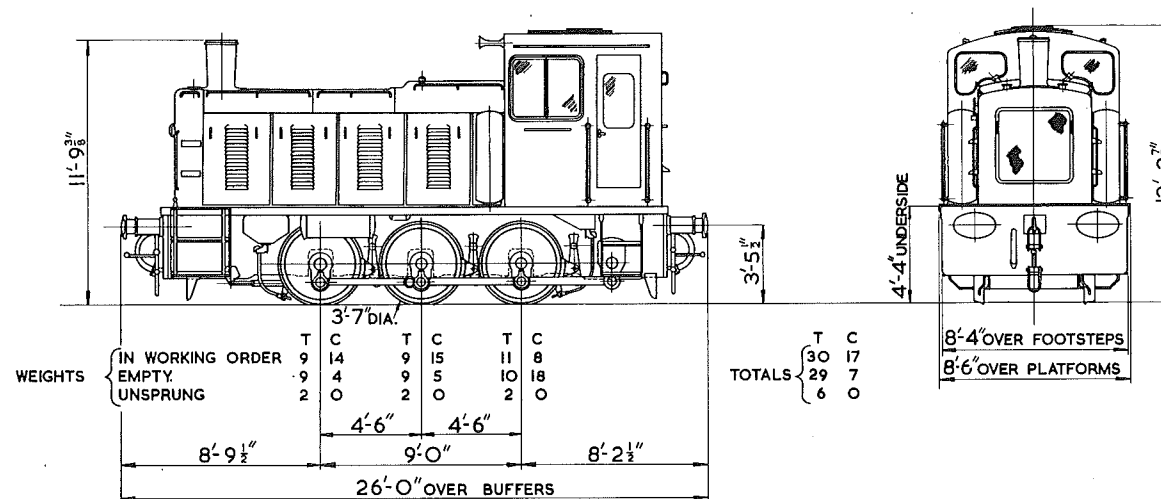

ENGINE	MAKE & TYPE	GARDNER 8 L.3.	BRAKING	TYPE	{ FOR LOCO FOR TRAIN	STRAIGHT AIR & AUTO AIR
	No. OF CYLS. & CYCLE	8 CYLS. 4 STROKE		BRAKE FORCE	{ % OF LOCO. WEIGHT IN WORKING ORDER	AUTO AIR & AIR CONT. VAC.
	MAX. CONT. RATED OUTPUT	204 H.P. AT 1200 R.P.M.				68.5%
TRANSMISSION	ENGINE TO GEARBOX	FLUIDRIVE TYPE 23 HYD. COUPLING	SPEED	MAX. PERMITTED SERVICE SPEED	28.5 M.P.H.	
	GEARBOX	WILSON-DREWRY C.A.5. R.7.		HORIZONTAL WITHOUT GAUGE WIDENING	2 CHAINS	
	FINAL DRIVE	S.C.G. Co. TYPE R.F. II.			HORIZONTAL WITH 3/4 INS. GAUGE WIDENING	1-1 CHAINS
PERFORMANCE	MAX. TRACTIVE EFFORT	15300 LB. AT 22.1% ADHESION	MINIMUM RADIUS CURVES	VERTICAL CONVEX	3 CHAINS	
	CONT. TRACTIVE EFFORT	15300 LB. AT 3.75 M.P.H.		VERTICAL CONCAVE	6.5 CHAINS	
	TANK CAPACITY	FUEL		300 GALLONS		

200 H.P. B.R. O-6-O DIESEL MECHANICAL SHUNTING LOCOMOTIVE  
CLASS O3





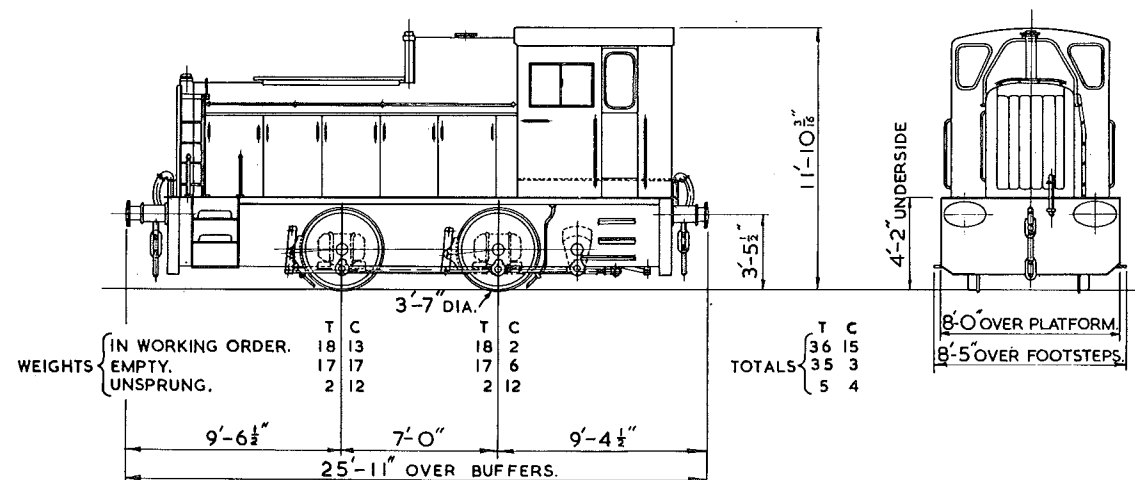

ENGINE.	{ MAKE & TYPE. No. OF CYLS. & CYCLE. MAX. CONT. RATED OUTPUT.	GARDNER 8L3. 8 CYLS. 4 STROKE. 204 H.P. AT 1200 R.P.M.	BRAKING.	{ TYPE { FOR LOCO. { FOR TRAIN.	AIR. VACUUM.
TRANSMISSION.	{ ENGINE TO GEARBOX. GEARBOX. FINAL DRIVE.	VULCAN SINCLAIR RIGID TYPE SIZE 23 H.T.O. CPLG. WILSON CA5 TYPE 5 SPEED EPICYCLIC GEARBOX. WISEMAN TYPE 15RLGB REVERSING F.D. UNIT.	SPEED.	{ BRAKE FORCE { % OF LOCO. WEIGHT { IN WORKING ORDER.	66.4%
PERFORMANCE	{ MAX. TRACTIVE EFFORT CONT. TRACTIVE EFFORT RAIL H.P.	19,800 LB. AT 24% ADHESION 19,800 LB. AT 2.25 M.P.H. 122 H.P. AVAILABLE BETWEEN 0 & 22.8 M.P.H.	CURVE.	{ MIN. RAD. CURVE { WITHOUT GAUGE WIDENING: { AT DEAD SLOW SPEED	22.8 M.P.H. 1:365 CHAINS. 1:365 CHAINS.
			TANK CAPACITY.	FUEL	325 GALLS.

**200 H.P. ANDREW BARCLAY O-4-O DIESEL MECHANICAL SHUNTING LOCOMOTIVE.  
CLASS O6**

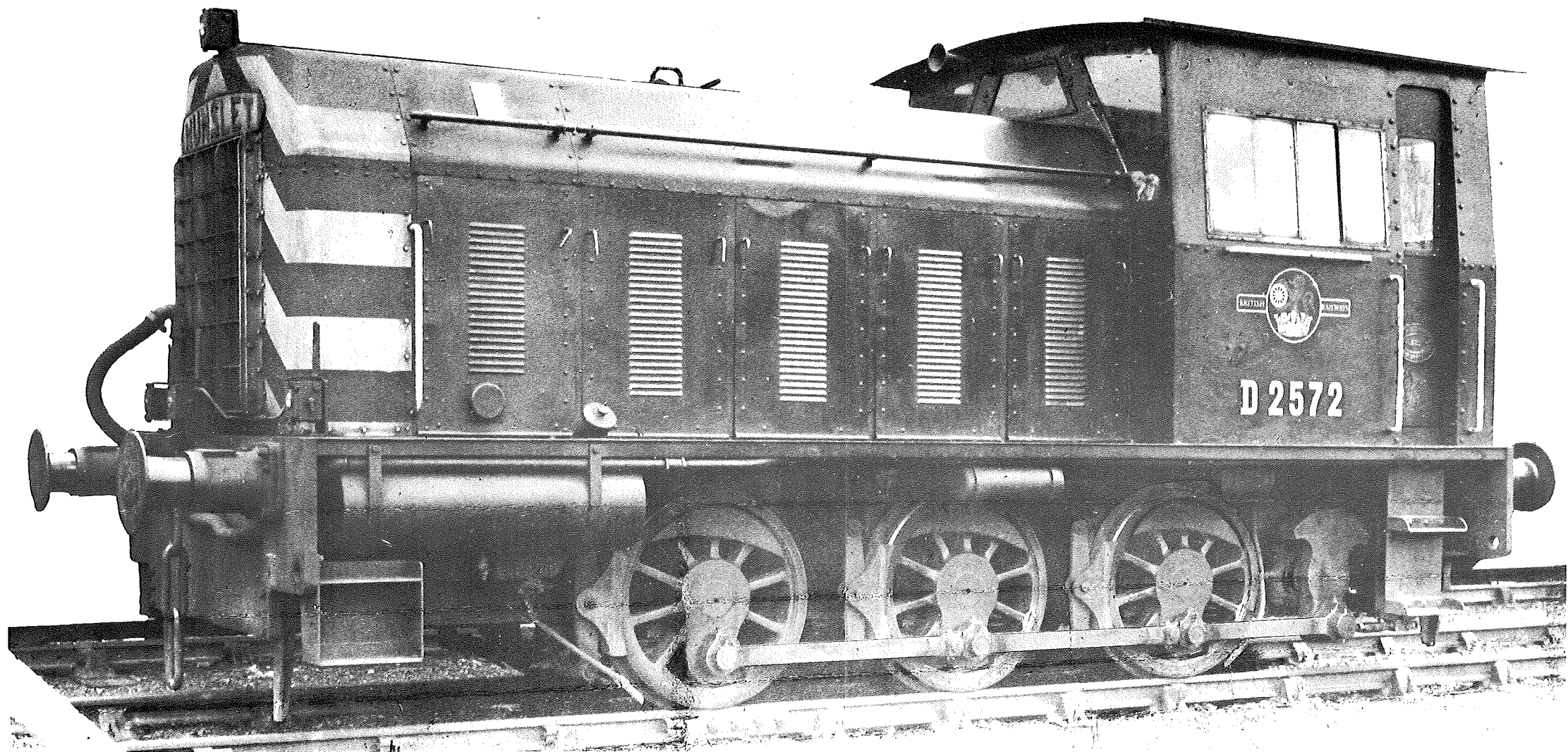

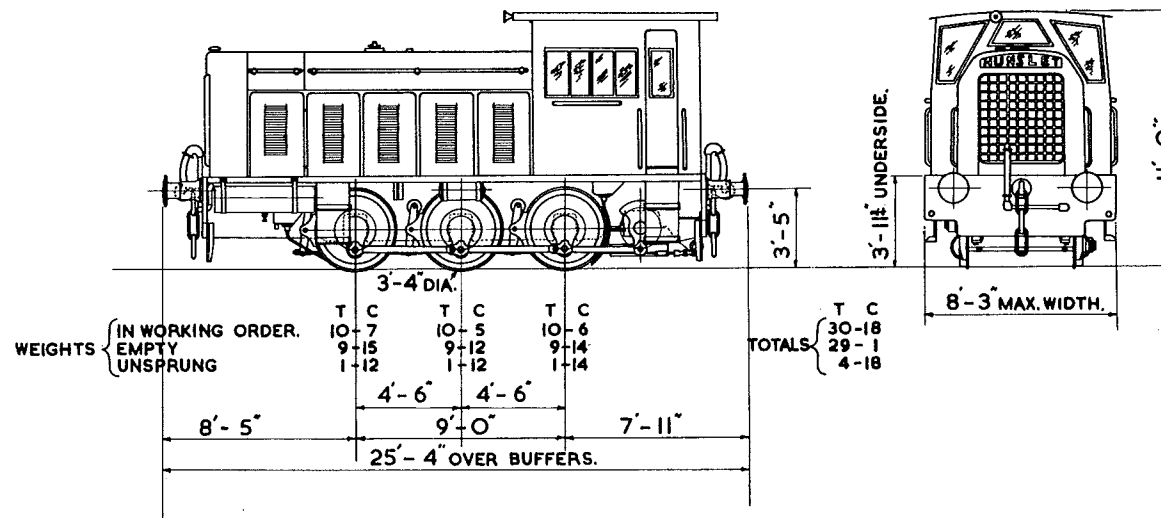

ENGINE. { MAKE & TYPE.  
 No. OF CYLS. & CYCLE.  
 MAX. CONT. RATED OUTPUT.  
 TRANSMISSION. { ENGINE TO GEARBOX.  
 GEARBOX.  
 FINAL DRIVE.  
 PERFORMANCE. { MAX. TRACTIVE EFFORT.  
 CONT. TRACTIVE EFFORT.

GARDNER 8.L.3.  
 8 CYLS. 4 STROKE.  
 204 H.P. AT 1200 R.P.M.  
 HUNSLET PATENT FRICTION CLUTCH.  
 HUNSLET FOUR SPEED.  
 JACKSHAFT & COUPLING RODS.  
 14,500 LB. AT 21.6% ADHESION.  
 14,500 LB. AT 4.48 M.P. H.

BRAKING.

TYPE. { FOR LOCO.  
 FOR TRAIN.  
 BRAKE FORCE. { % OF LOCO. WEIGHT  
 IN WORKING ORDER.

AIR.  
 VACUUM.

SPEED.

MAX. PERMITTED SERVICE SPEED.

17.8 M.P. H.

CURVE.

MIN. RAD. CURVE { WITHOUT GAUGE WIDENING:  
 AT DEAD SLOW SPEED:

1.82 CHAINS.

1.52 CHAINS.

TANK CAPACITY.

FUEL.

300 GALLS.

200 H.P HUNSLET O-6-O DIESEL MECHANICAL SHUNTING LOCOMOTIVE.  
 CLASS O5

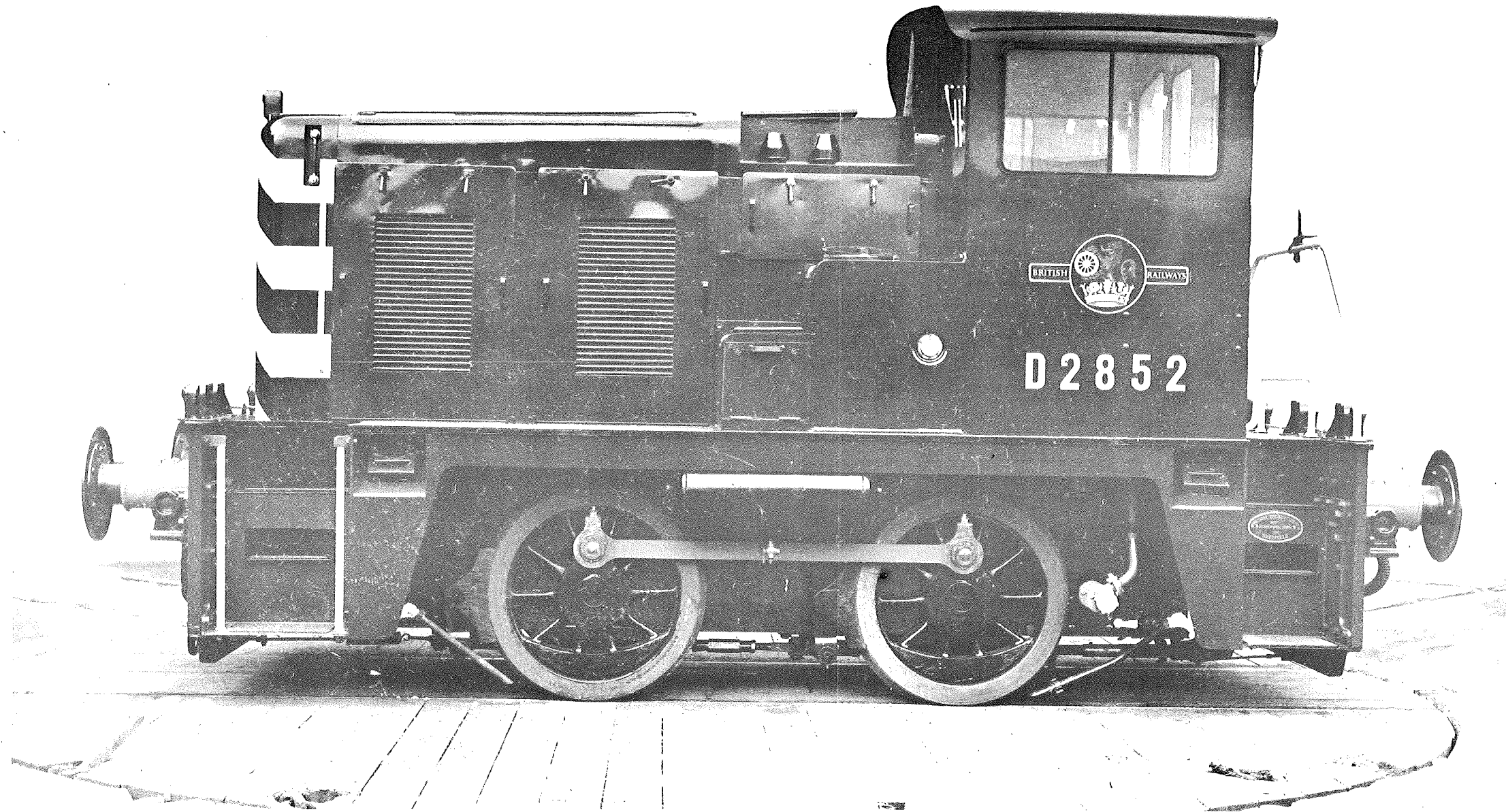

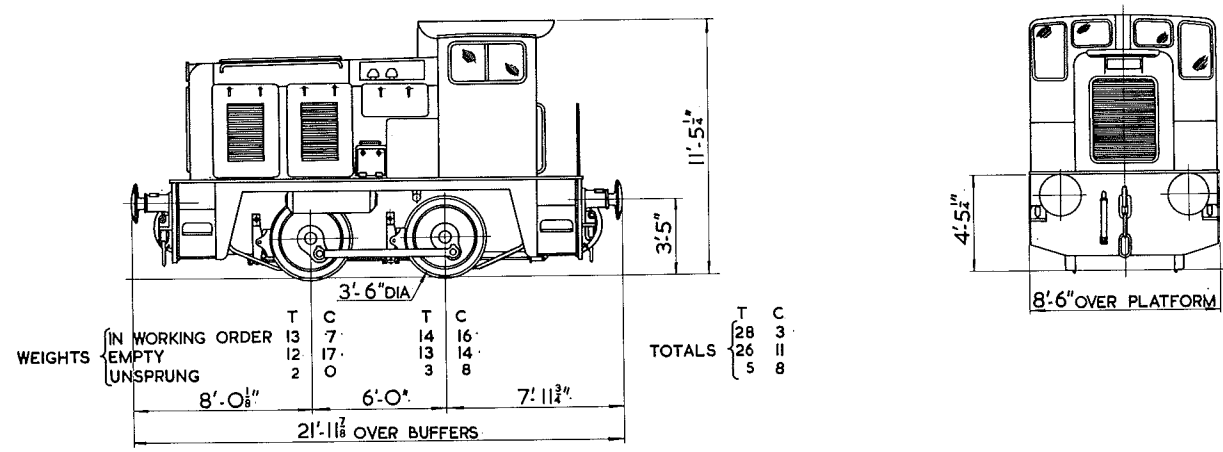

ENGINE:	{ MAKE & TYPE. No. OF CYLS. & CYCLE. MAX. CONT. RATED OUTPUT.	ROLLS ROYCE C.6. N.F.L. SERIES 176. 6 CYLS. 4 STROKE. 170 H.P. AT 1800 R.P.M.	BRAKING:	{ TYPE. { FOR LOCO. FOR TRAIN. BRAKE FORCE. { % OF LOCO. WEIGHT IN WORKING ORDER.	AIR. VACUUM. 75%.
TRANSMISSION:	{ MAKE & TYPE. FINAL DRIVE.	"ROLLS ROYCE" TORQUE CONVERTER. "YORKSHIRE" DOUBLE REDUCTION REVERSING GEARBOX.	SPEED.	MAX. PERMITTED SERVICE SPEED.	19.5 M.P.H.
PERFORMANCE:	{ MAX. TRACTIVE EFFORT. CONT. TRACTIVE EFFORT. RAIL H.P.	15,000 LB. AT 23.8% ADHESION. 13,700 LB. AT 1.4 MPH 100 H.P. AVAILABLE BETWEEN 4 & 15 M.P.H.	CURVE.	MIN. RAD. CURVE. { WITHOUT GAUGE WIDENING. AT DEAD SLOW SPEED.	60 FEET.
			TANK CAPACITY.	FUEL;	300 GALLS.

170H.P. YORKSHIRE ENGINE O-4-O DIESEL HYDRAULIC SHUNTING LOCOMOTIVE.  
CLASS Q2







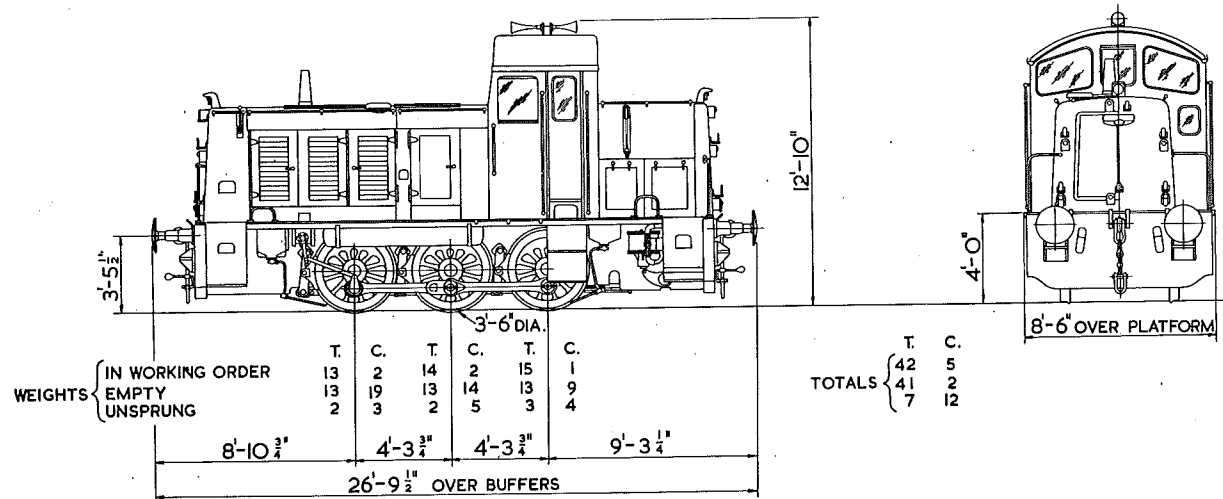

ENGINE	{	MAKE & TYPE	PAXMAN 6 RPHL. MK.III
		No. OF CYLS. & CYCLE	6 CYLS., 4 STROKE
		MAX. CONT. RATED OUTPUT	275 H.P. AT 1360 R.P.M.
MAIN GENERATOR	{	MAKE & TYPE	A.E.I. RTB 6652
		MAKE & TYPE	A.E.I. RTA 6652
TRACTION MOTORS.	{	No.	ONE
		TYPE OF SUSPENSION	AXLE
		TYPE OF GEAR DRIVE	DOUBLE REDUCTION
		MAX. TRACTIVE EFFORT	28,240 LBS. AT 30% ADHESION
			AT 390 AMPS. MAIN GENERATOR
PERFORMANCE	{	CONT. TRACTIVE EFFORT	15,950 LBS. AT 4.38 M.P.H.
			AT 360 AMPS. MAIN GENERATOR
		RAIL H.P. AT CONT. RATING	190 H.P.
		FULL ENGINE OUTPUT	AVAILABLE BETWEEN 3.9 & 13.5 M.P.H.

BRAKING	{	TYPE { FOR LOCO.	STRAIGHT AIR
		{ FOR TRAIN	VACUUM
		BRAKE FORCE { % OF LOCO. WEIGHT	84
		{ IN WORKING ORDER	
SPEED		MAX. PERMITTED SERVICE SPEED	20 M.P.H.
CURVE		MIN. RAD. CURVE WITHOUT GAUGE WIDENING	2 CHAINS
TANK CAPACITY		ENGINE FUEL	300 GALLS.

**275 H.P. RUSTON & HORNSBY O-6-O DIESEL ELECTRIC SHUNTING LOCOMOTIVE**

**CLASS 7**

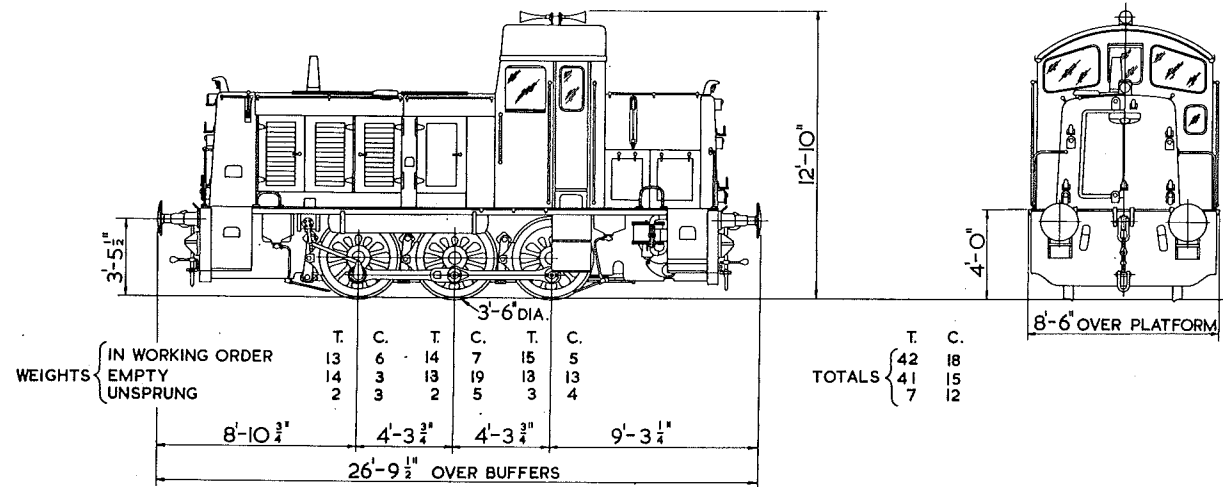

ENGINE	{ MAKE & TYPE No. OF CYLS. & CYCLE MAX. CONT. RATED OUTPUT	PAXMAN 6 RPHL. MK.III 6 CYLS., 4 STROKE 275 H.P. AT 1360 R.P.M.	BRAKING.	{ TYPE { FOR LOCO. FOR TRAIN. BRAKE FORCE { % OF LOCO. WEIGHT. IN WORKING ORDER.	STRAIGHT AIR & AUTO. AIR AUTO AIR & AIR <del>CONTROL</del>
MAIN GENERATOR	{ MAKE & TYPE	A.E.I. RTB 6652	SPEED.	MAX. PERMITTED SERVICE SPEED.	82.9%
TRACTION MOTORS	{ MAKE & TYPE No. TYPE OF SUSPENSION TYPE OF GEAR DRIVE MAX. TRACTIVE EFFORT	A.E.I. RTA 6652 ONE AXLE DOUBLE REDUCTION 28,240 LBS. AT 29.4% ADHESION.	MINIMUM RADIUS CURVES.	{ HORIZONTAL WITHOUT GAUGE WIDENING. HORIZONTAL WITH 3/4 INS. GAUGE WIDENING. VERTICAL CONVEX. VERTICAL CONCAVE.	20 M.P.H. 2 CHAINS. 1 CHAIN. 113 CHAINS. 1 CHAIN.
PERFORMANCE	{ CONT. TRACTIVE EFFORT RAIL H.P. AT CONT. RATING FULL ENGINE OUTPUT	AT 390 AMPS. MAIN GENERATOR. 15,950 LBS. AT 4.38 M.P.H. AT 360 AMPS. MAIN GENERATOR. 190 H.P. AVAILABLE BETWEEN 3.9 & 13.5 M.P.H.	TANK CAPACITY.	ENGINE FUEL.	300 GALLS.

**275 H.P. RUSTON & HORNSBY O-6-O DIESEL ELECTRIC SHUNTING LOCOMOTIVE  
CLASS O7.**



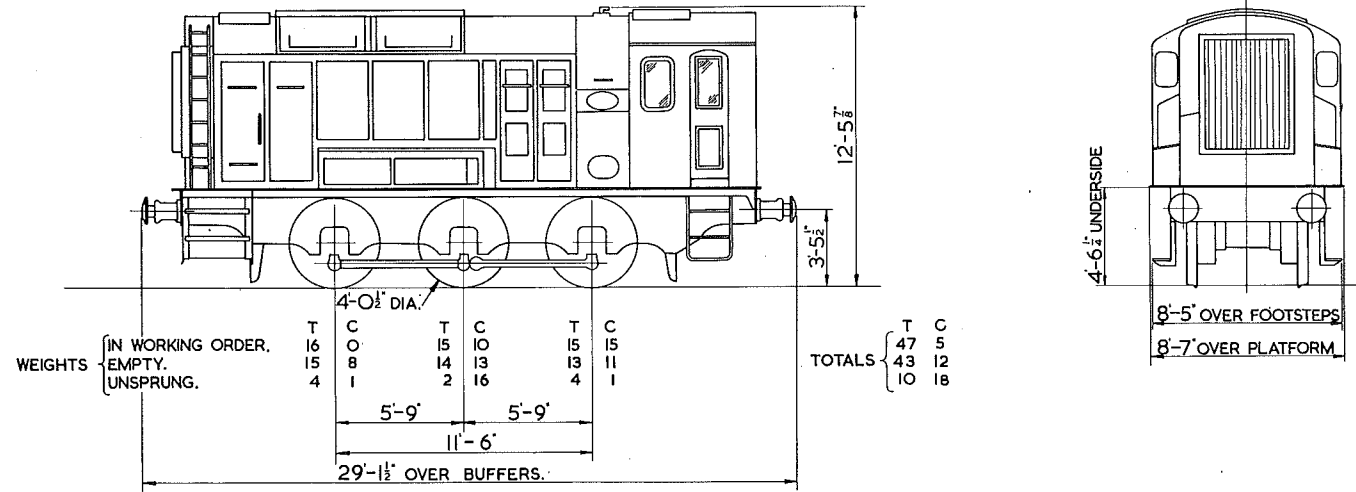

ENGINE.	{ MAKE & TYPE, No. OF CYLS. & CYCLE. MAX. CONT. RATED OUTPUT.	ENGLISH ELECTRIC 6 KT. 6 CYL. 4 STROKE. 350 H.P. AT 680 R.P.M.	BRAKING.	{ TYPE { FOR LOCO FOR TRAIN. BRAKE FORCE { % OF LOCO WEIGHT IN WORKING ORDER.	AIR. 68.9 %.
MAIN GENERATOR.	{ MAKE & TYPE.	ENGLISH ELECTRIC TYPE E.E. 80I.	SPEED.	MAX. PERMITTED SERVICE SPEED.	20 M.P.H.
TRACTION MOTORS.	{ MAKE & TYPE. No. TYPE OF SUSPENSION. TYPE OF GEAR DRIVE. MAX. TRACTIVE EFFORT.	ENGLISH ELECTRIC TYPE EE 506. TWO. NOSE. DOUBLE REDUCTION. 35,000 L.B. AT 33.2% ADHESION. AT 1050 AMPS. MAIN GENERATOR.	CURVE.	MIN. RAD. CURVE { WITHOUT GAUGE WIDENING. AT DEAD SLOW SPEED.	3 CHAINS.
PERFORMANCE.	{ CONT. TRACTIVE EFFORT. RAIL H.P. AT CONT. RATING. FULL ENGINE OUTPUT.	10800 L.B. AT 8.5 M.P.H. AT 441 AMPS. MAIN GENERATOR. 245 H.P. AVAILABLE BETWEEN 0 & 8.5 M.P.H.	TANK CAPACITY.	FUEL	660 GALLS.

**350 H.P. B.R. 0-6-0 DIESEL ELECTRIC SHUNTING LOCOMOTIVE.  
CLASS II**

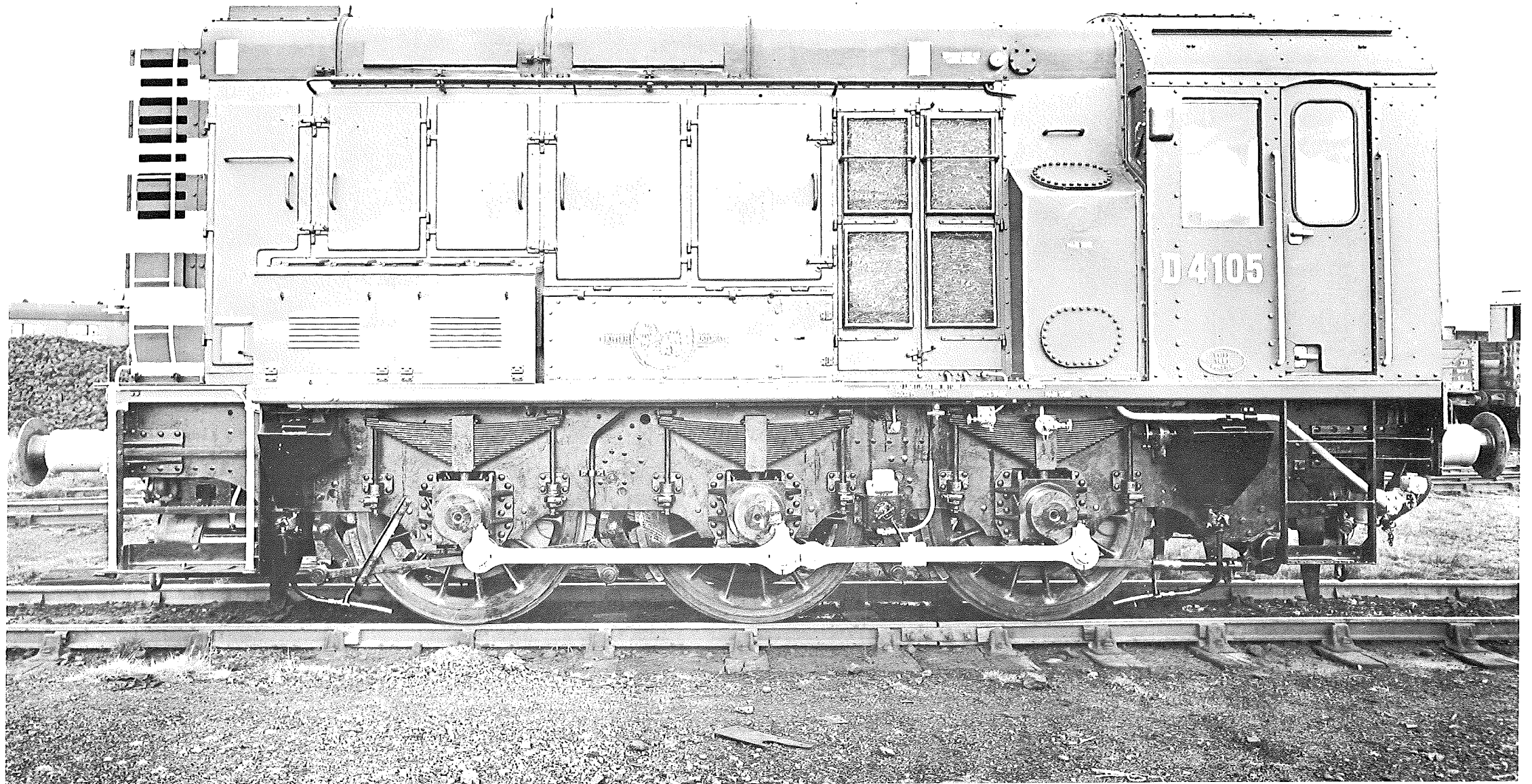

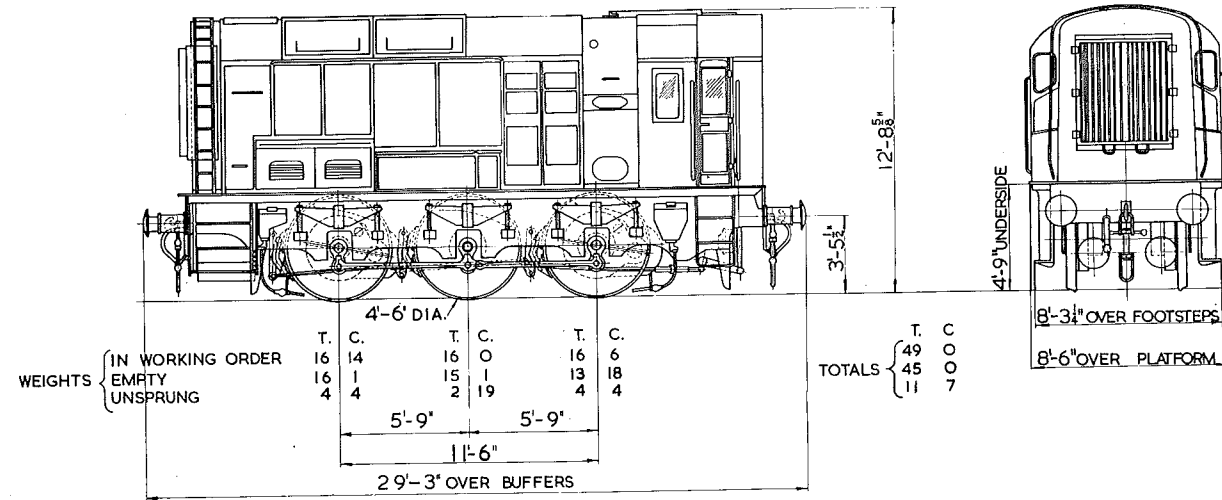

ENGINE.	{ MAKE & TYPE.	ENGLISH ELECTRIC 6.K.T.	BRAKING.	{ TYPE { FOR LOCO.	AIR.
	{ No. OF CYLS. & CYCLE.	6 CYLS. 4 STROKE.		{ FOR TRAIN.	VACUUM.
MAIN GENERATOR.	{ MAX. CONT. RATED OUTPUT.	400 H.P. AT 680 R.P.M.		{ BRAKE FORCE { % OF LOCO. WEIGHT	66.2%.
	{ MAKE & TYPE.	ENGLISH ELECTRIC 80I.		{ IN WORKING ORDER.	
TRACTION MOTORS	{ MAKE & TYPE.	ENGLISH ELECTRIC 506.	SPEED.	{ MAX. PERMITTED SERVICE SPEED.	20 M.P.H.
	{ No.	TWO.	CURVE.	{ MIN. RAD. CURVE { WITHOUT GAUGE WIDENING.	3 CHAINS.
	{ TYPE OF SUSPENSION.	NOSE.		{ AT DEAD SLOW SPEED.	
	{ TYPE OF GEAR DRIVE.	DOUBLE REDUCTION.	TANK CAPACITY. FUEL.		668 GALLS.
	{ MAX. TRACTIVE EFFORT.	35000 LB. AT 31.9% ADHESION			
PERFORMANCE.	{ CONT. TRACTIVE EFFORT.	AT 1020 AMPS. MAIN GENERATOR.			
		11,100 LB. AT 8.8 M.P.H.			
	{ RAIL H.P. AT CONT. RATING.	AT 441 AMPS. MAIN GENERATOR.			
	{ FULL ENGINE OUTPUT.	260 H.P.			
		AVAILABLE BETWEEN 0 & 7.9 M.P.H.			

350 H.P. B.R. O-6-O DIESEL ELECTRIC SHUNTING LOCOMOTIVE.

CLASS O8



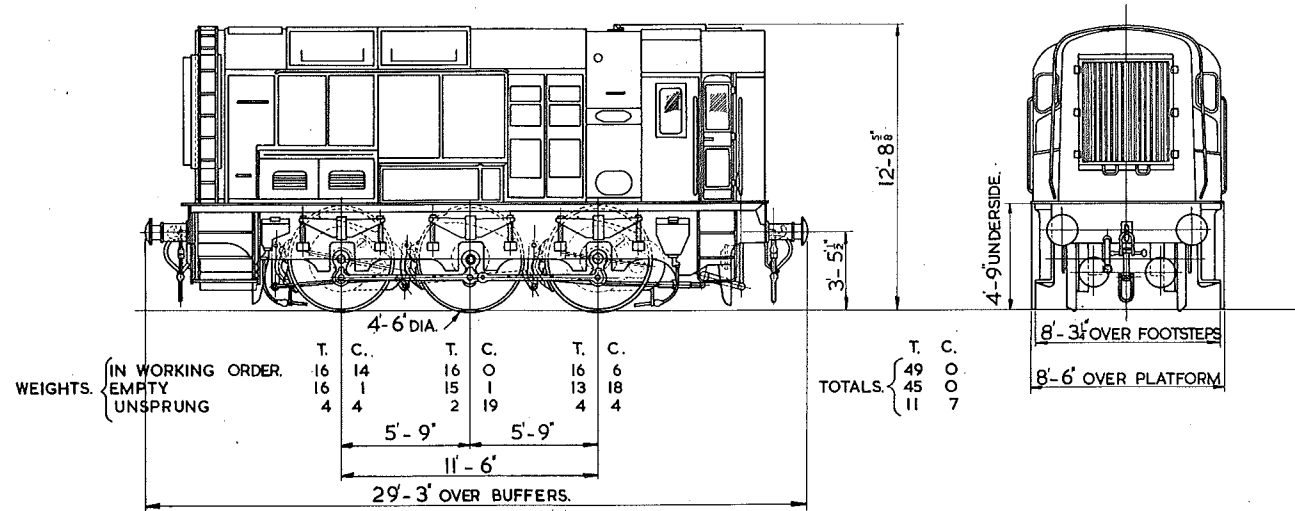

ENGINE.	{ MAKE & TYPE.	ENGLISH ELECTRIC 6.K.T.			
	{ No. OF CYLS. & CYCLE.	6 CYLS. 4 STROKE.			
	{ MAX. CONT. RATED OUTPUT.	400 H.P. AT 680 R.P.M.	BRAKING.	{ TYPE. { FOR LOCO.	AIR
MAIN GENERATOR.	{ MAKE & TYPE.	ENGLISH ELECTRIC 80I.		{ FOR TRAIN.	VACUUM.
	{ MAKE & TYPE.	ENGLISH ELECTRIC 506.		{ BRAKE FORCE. { % OF LOCO. WEIGHT	66.2 %.
	{ No.	TWO.	SPEED.	{ IN WORKING ORDER.	
TRACTION MOTORS.	{ TYPE OF SUSPENSION.	NOSE.		{ MAX. PERMITTED SERVICE SPEED.	27.5 M.P.H.
	{ TYPE OF GEAR DRIVE.	DOUBLE REDUCTION.	CURVE.	{ MIN RAD CURVE. { WITHOUT GAUGE WIDENING.	3 CHAINS.
	{ MAX. TRACTIVE EFFORT	25000 LB. AT 22.8% ADHESION		{ AT DEAD SLOW SPEED.	
	{ CONT. TRACTIVE EFFORT.	AT 1000 AMPS. MAIN GENERATOR.	TANK CAPACITY.	{ FUEL.	668 GALLS.
PERFORMANCE.	{ RAIL H.P. AT CONT. RATING.	8700 LB. AT 11.6 M.P.H.			
	{ FULL ENGINE OUTPUT.	AT 465 AMPS. MAIN GENERATOR.			
		269 H.P.			
		AVAILABLE BETWEEN 0 & 9.4 M.P.H.			

**350 H.P. B.R. O-6-O DIESEL ELECTRIC SHUNTING LOCOMOTIVE.**  
**CLASS O9**

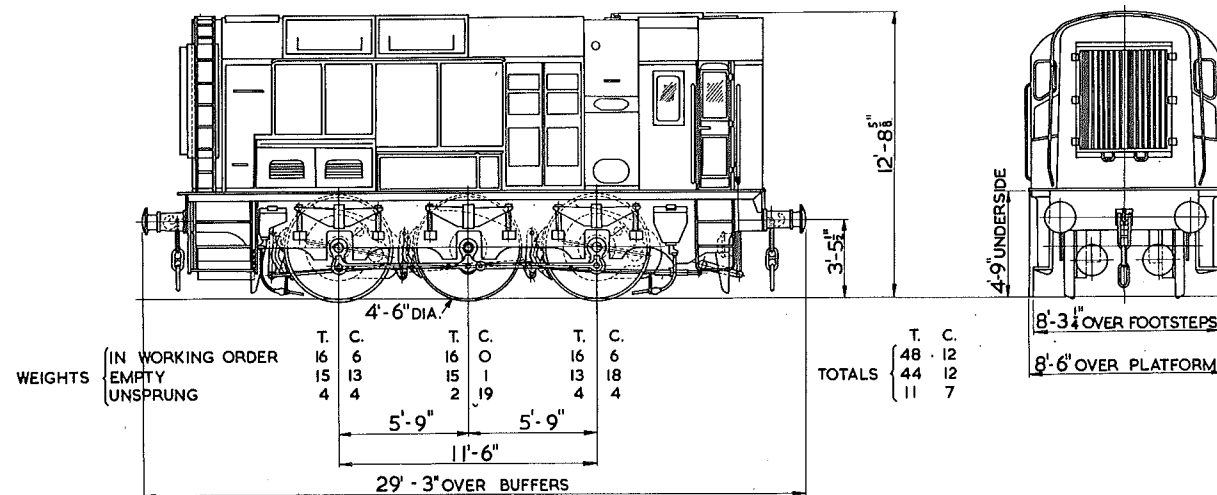

ENGINE.	MAKE & TYPE.	ENGLISH ELECTRIC 6.K.T.	BRAKING.	TYPE	{ FOR LOCO. FOR TRAIN.	AIR.
	No. OF CYLS. & CYCLE.	6 CYLS. 4 STROKE.		BRAKE FORCE	{ % OF LOCO. WEIGHT IN WORKING ORDER.	66.6%.
MAIN GENERATOR.	MAKE & TYPE.	ENGLISH ELECTRIC 80I.	SPEED.	MAX. PERMITTED SERVICE SPEED.		20 M.P.H.
TRACTION MOTORS.	MAKE & TYPE.	ENGLISH ELECTRIC 506.	CURVE.	MIN. RAD. CURVE	{ WITHOUT GAUGE WIDENING. AT DEAD SLOW SPEED.	3 CHAINS.
	No.	TWO.	TANK CAPACITY. FUEL.			668 GALLS.
	TYPE OF SUSPENSION.	NOSE.				
	TYPE OF GEAR DRIVE.	DOUBLE REDUCTION.				
	MAX. TRACTIVE EFFORT.	35000 LB. AT 32.1% ADHESION				
PERFORMANCE.	CONT. TRACTIVE EFFORT.	AT 1020 AMPS. MAIN GENERATOR.				
	RAIL H.P. AT CONT. RATING.	11,100 LB. AT 8.8 M.P.H.				
	FULL ENGINE OUTPUT.	AT 441 AMPS. MAIN GENERATOR.				
		260 H.P.				
		AVAILABLE BETWEEN 0 & 7.9 M.P.H.				

**350H.P. B.R. O-6-O DIESEL ELECTRIC SHUNTING LOCOMOTIVE.**

**CLASS O8**

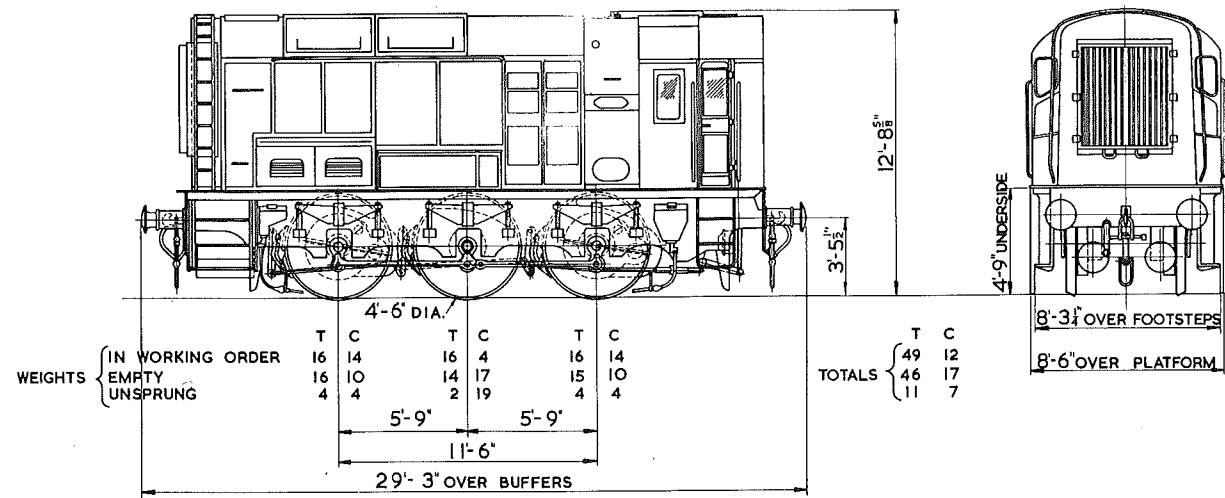

ENGINE	MAKE & TYPE	ENGLISH ELECTRIC 6.K.T.	BRAKING	TYPE	FOR LOCO	STRAIGHT AIR & AUTO AIR
	No. OF CYLS. & CYCLE	6 CYLS. 4 STROKE		FOR TRAIN		AUTO AIR & AIR CONT. VAC.
MAIN GENERATOR	MAX. CONT. RATED OUTPUT	400 H.P. AT 680 R.P.M.		BRAKE FORCE	% OF LOCO. WEIGHT	65.4%
	MAKE & TYPE	ENGLISH ELECTRIC 801	SPEED	IN WORKING ORDER		
TRACTION MOTORS	MAKE & TYPE	ENGLISH ELECTRIC 506		MAX. PERMITTED SERVICE SPEED		20 M.P.H.
	No.	TWO	MINIMUM RADIUS	HORIZONTAL WITHOUT GAUGE WIDENING		3 CHAINS
	TYPE OF SUSPENSION	NOSE	CURVES	HORIZONTAL WITH 3/4 INS. GAUGE WIDENING		1.8 CHAINS
	TYPE OF GEAR DRIVE	DOUBLE REDUCTION		VERTICAL CONVEX		3 CHAINS
	MAX. TRACTIVE EFFORT	35000 LB. AT 31.5% ADHESION	TANK CAPACITY	VERTICAL CONCAVE		5.5 CHAINS
PERFORMANCE	CONT. TRACTIVE EFFORT	AT 1020 AMPS. MAIN GENERATOR		FUEL		668 GALLONS
	AT 1020 AMPS. MAIN GENERATOR	11,100 LB. AT 8.8 M.P.H.				
	AT 441 AMPS. MAIN GENERATOR	260 H.P.				
	RAIL H.P. AT CONT. RATING	AVAILABLE BETWEEN 0 & 7.9 M.P.H.				
	FULL ENGINE OUTPUT					

350 H.P. B.R. O-6-O DIESEL ELECTRIC SHUNTING LOCOMOTIVE  
CLASS O8

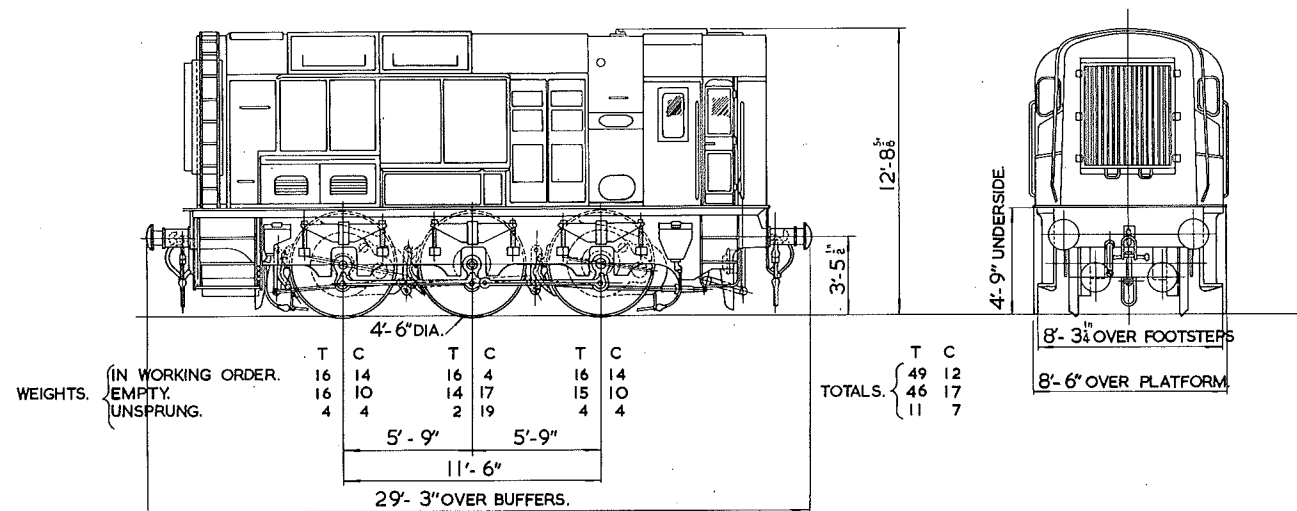

ENGINE.	MAKE & TYPE.	ENGLISH ELECTRIC 6.K.T.	BRAKING.	TYPE. { FOR LOCO. FOR TRAIN.	STRAIGHT AIR & AUTO. AIR. AUTO. AIR & AIR. CONT. VAC.
	No. OF CYLS. & CYCLE.	6 CYLS. 4 STROKE.		BRAKE FORCE. { % OF LOCO. WEIGHT. IN WORKING ORDER.	65.4%
MAIN GENERATOR.	MAX. CONT. RATED OUTPUT.	400 H.P. AT 680 R.P.M.	SPEED.	MAX. PERMITTED SERVICE SPEED.	27.5 M.P.H.
	MAKE & TYPE.	ENGLISH ELECTRIC 801.	MINIMUM RADIUS.	{ HORIZONTAL WITHOUT GAUGE WIDENING. HORIZONTAL WITH 3/4 INS. GAUGE WIDENING.	3 CHAINS. 1.8 CHAINS.
TRACTION MOTORS.	MAKE & TYPE.	ENGLISH ELECTRIC 506.	CURVES.	VERTICAL CONVEX. VERTICAL CONCAVE.	3 CHAINS. 5.5 CHAINS.
	No.	TWO.	TANK CAPACITY.	FUEL.	668 GALLONS.
	TYPE OF SUSPENSION.	NOSE.			
	TYPE OF GEAR DRIVE.	DOUBLE REDUCTION.			
PERFORMANCE.	MAX. TRACTIVE EFFORT.	25,000 LB. AT 22.5% ADHESION. AT 1000 AMPS MAIN GENERATOR.			
	CONT. TRACTIVE EFFORT.	8,700 LB. AT 11.6 M.P.H. AT 465 AMPS. MAIN GENERATOR.			
	RAIL H.P. AT CONT. RATING.	269 H.P.			
	FULL ENGINE OUTPUT.	AVAILABLE BETWEEN 0 & 9.4 M.P.H.			

**350 H.P. B.R. 0 - 6 - 0 DIESEL ELECTRIC SHUNTING LOCOMOTIVE.  
CLASS 09**



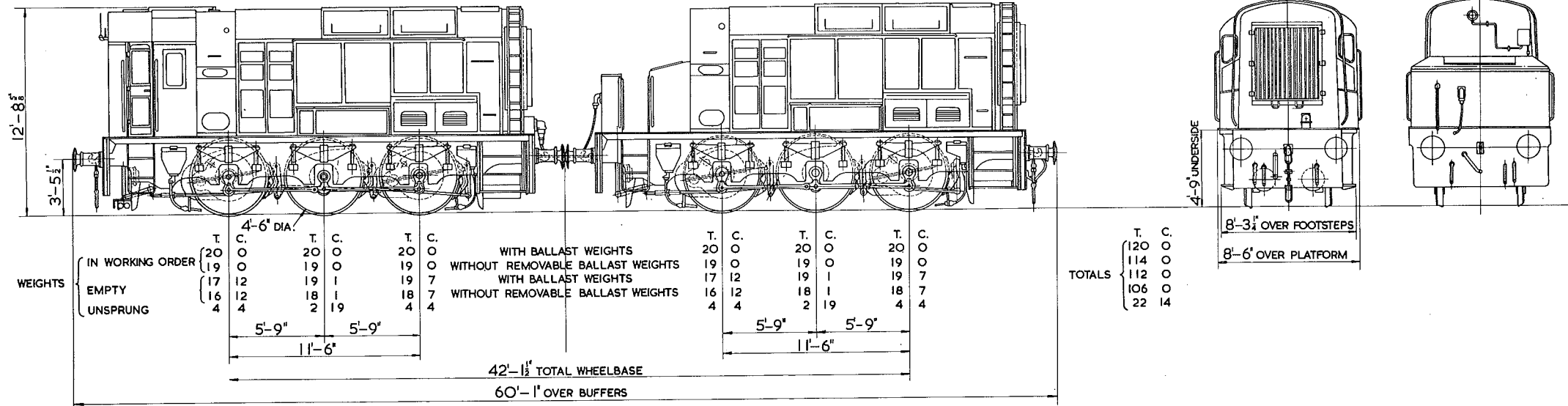

ENGINE.	{ MAKE & TYPE. No. OF CYLS. & CYCLE. MAX. CONT. RATED OUTPUT.	TWO-ENGLISH ELECTRIC 6.K.T. 6 CYLS. 4 STROKE. 400 H.P. AT 680 R.P.M. EACH.	BRAKING.	{ TYPE { FOR LOCO. FOR TRAIN.	AIR. VACUUM.
MAIN GENERATOR.	{ MAKE & TYPE.	TWO-ENGLISH ELECTRIC 801.	SPEED.	{ BRAKE FORCE. { % OF LOCO. WEIGHT. IN WORKING ORDER.	54%
TRACTION MOTORS	{ MAKE & TYPE. No. TYPE OF SUSPENSION. TYPE OF GEAR DRIVE.	ENGLISH ELECTRIC 506. FOUR. NOSE. DOUBLE REDUCTION.	MINIMUM RADIUS CURVES.	{ MAX. PERMITTED SERVICE SPEED. HORIZONTAL WITHOUT GAUGE WIDENING. HORIZONTAL WITH 3/4 IN. GAUGE WIDENING. VERTICAL CONVEX. VERTICAL CONCAVE.	20 M.P.H. 3 CHAINS. 1.79 CHAINS. 2.5 CHAINS. 9 CHAINS.
PERFORMANCE (WITH MOTORS IN SERIES)	{ MAX. TRACTIVE EFFORT.  CONT. TRACTIVE EFFORT.  RAIL H.P. AT CONT. RATING. FULL ENGINE OUTPUT.	70,000 LB. AT 26% ADHESION. AT 500 AMPS. EACH MAIN GENERATOR. 32,000 LB. AT 3.75 M.P.H. AT 280 AMPS. EACH MAIN GENERATOR. (IN SERIES, MOTORS ARE LIMITING) 320 H.P. AVAILABLE ON NOTCH 4 AT 485 AMPS. AT 2.2 M.P.H.	TANK CAPACITY.	{ ENGINE FUEL.	1336 GALLS.

**700 H.P. B.R. 0-6-0 + 0-6-0 DIESEL ELECTRIC SHUNTING LOCOMOTIVE.  
CLASS 13**